

IP65 Surface LED Luminaires

INSTALLATION INSTRUCTIONS

1. What is in inner box package



2. Step

Ensure that power is turned off before installation.

Carefully remove the PC cover through opening the metal clip, then remove aluminum plate through rotating the plastic knob.

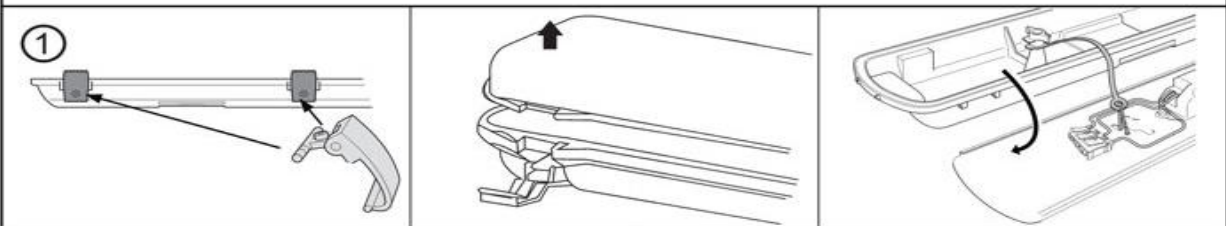

① Screw two pieces metal bracket (packed in the accessory bag) to ceiling; install the housing to the metal bracket.

Install the end cap, connect wiring to terminal block of the light through the cable entry hole.

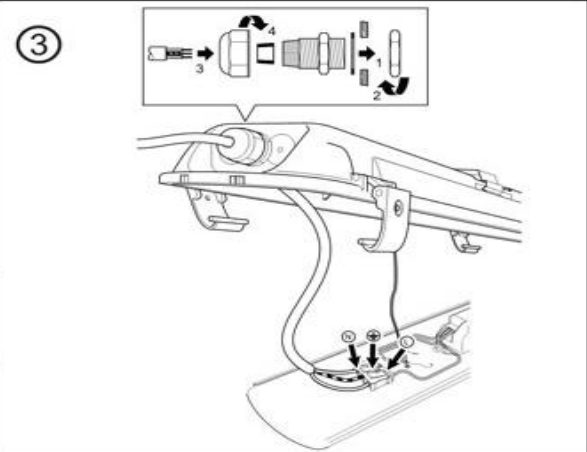
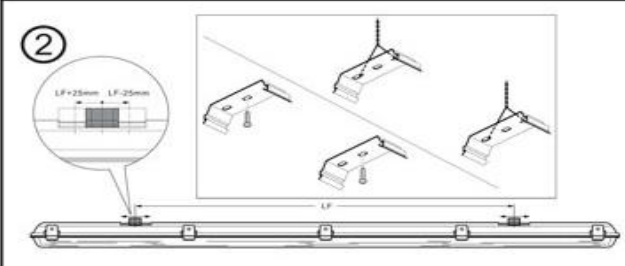

Re-install the aluminum plate and PC cover to the housing.

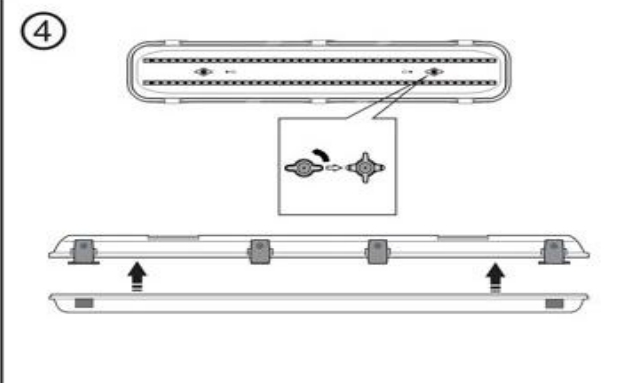

Fasten the metal clips.

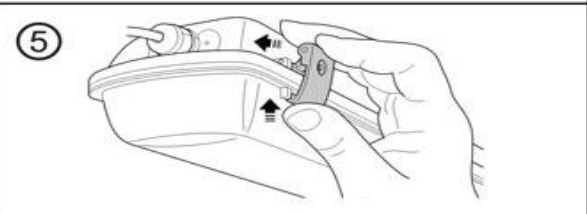

3. Warning

- 1). The Lamp is only for Indoor and Dry application, keep away from Heat, Steam, Wet, Oil, Corrosion etc, which may affect its permanence and shorten the lifespan.
- 2). Please strictly follow the instructions while installation to avoid any Hazard or damages.
- 3). Any installation, or maintenance should be done by professional, do not DIY if without enough knowledge.
- 4). Please double check before turn on if wiring is 100% OK, make sure Voltage for lamp is right and no Short-Circuit.
- 5). Please do not block any objects on the lamp, which will definitely affect heat emission while lamp's working.